

ACTUATOR SHOWN AT MIDSTROKE

REVISION TABLE					
REV	ECN#	DESCRIPTION	REV BY	APPROVED	DATE
---	---	Original Drawing	SDC	MPW	7-11-17
A	2027	Changed lead exit from radial to axial.	LLR	MPW	2-5-18

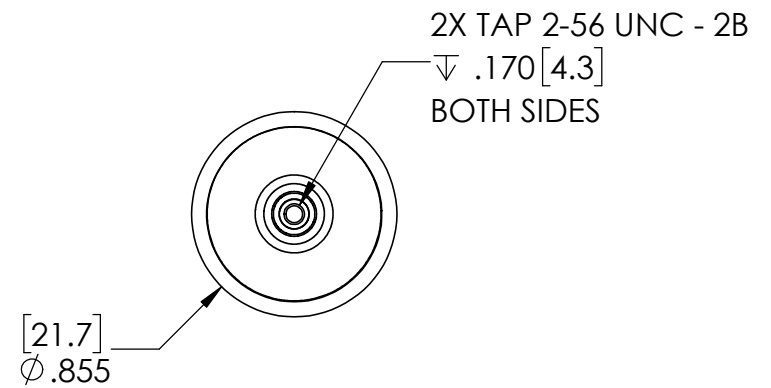
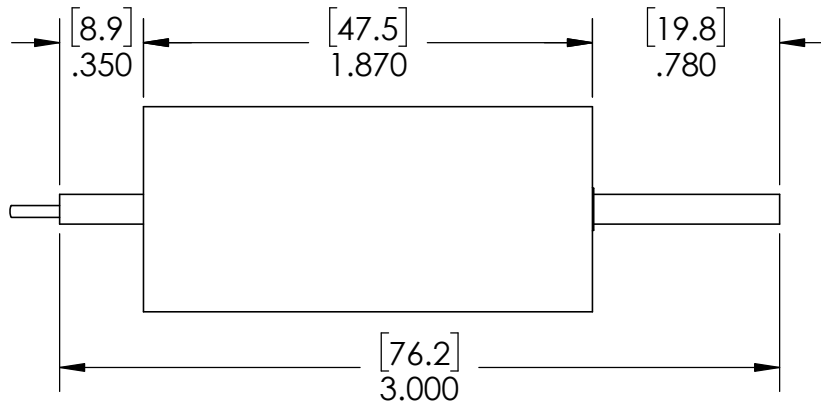
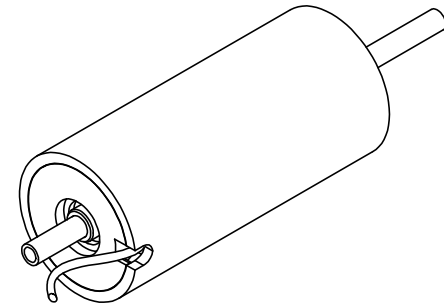
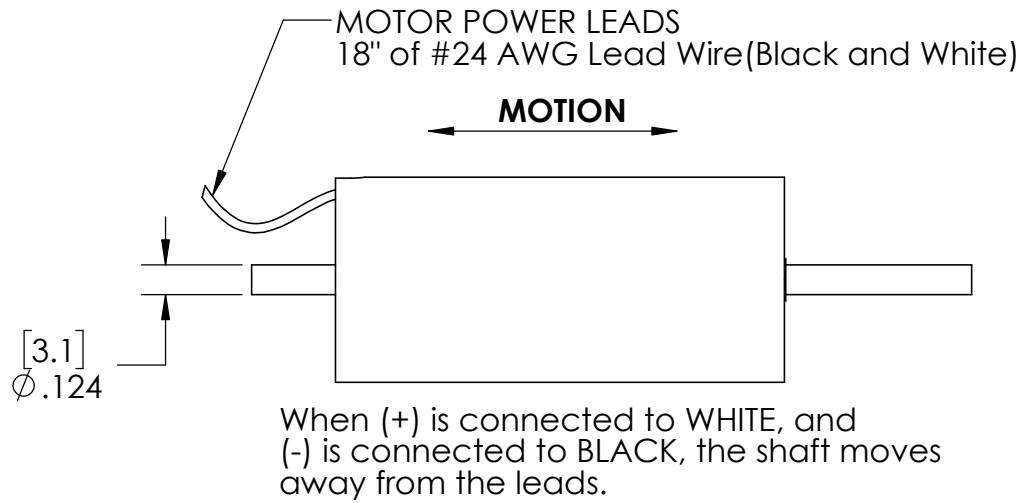

1

2

3

4

5

A

A

B

B

C

C

D

D

MOVING MAGNET VOICE COIL ACTUATOR SPECIFICATIONS

Motor P/N	NCM06-08-008-2IB	
Stroke	0.60"	15.2 mm
Bearing Type	Sliding Contact	
Moving Mass	0.05 lbs	25 grams
Total Mass	0.17 lbs	75 grams
Resistance @ 20C	1.5 ohms	
Inductance @ 20C	0.3 mH	
Electrical Time Constant	0.20 msec	
Motor Constant	0.40 LBS/SQRT(Watt)	1.78 N/SQRT(Watt)
Force Constant	0.49 LBS/Amp	2.18 N/Amp
Back EMF	0.06 V/ips	2.18 V/m/sec
Continuous Force	1.12 LBS	5.0 N
Max Power @ 100% Duty	8 Watts	
Peak Force	3.36 LBS	15.0 N
Max Power @ 10% Duty	73 Watts	

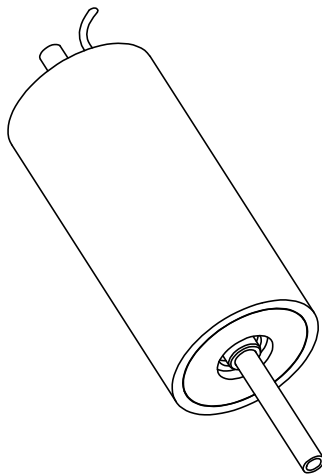
**H2W Technologies, Inc.**Santa Clarita, CA 91350 USA
Tel: (661) 291-1620www.h2wtech.com

These drawings and specifications are the property of H2W Technologies, Inc. They are issued in confidence and shall not be reproduced, copied, or used without written permission from H2W Technologies, Inc.

UNLESS SPECIFIED OTHERWISE:
All dimensions are in inches
Standard Tolerances are as follows
.XXX ±.005 ANGLES ±.1°
.XX ±.010 FILLETS .010
.X ±.020 CORNERS .010
Remove All Burrs and Sharp Edges

**FOR
REFERENCE
ONLY**

MATERIAL

FINISH

TITLE

Voice Coil Actuator Model #:

NCM06-08-008-2IB

DWG #

30-1308

REV

DATE

7-11-17

SHEET

2 of 2